

FLANGE COMPARISON TABLE (mm)

■ JIS Flange (JIS B2220 : 2004)

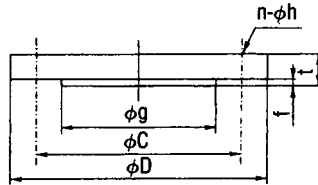

f (in case of Raised Face flange)

For nominal width 1	1
For nominal width 1/4 to 5	2

Nominal width	Nominal pres.	JIS 5K (kg/cm ²)						JIS 10K (kg/cm ²)					
		D	C	g	t	n-h	Bolts	D	C	g	t	n-h	Bolts
1B	25A	95	75	59	1	4-12	M10	125	9	67	14	4-19	M16
1-1/4B	32A	115	9	7	12	4-15	M12	135	1	76	16	4-19	M16
1-1/2B	4 A	12	95	75	12	4-15	M12	14	1 5	81	16	4-19	M16
2B	5 A	13	1 5	85	14	4-15	M12	155	12	96	16	4-19	M16
2-1/2B	65A	155	13	11	14	4-15	M12	175	14	116	18	4-19	M16
3B	8 A	18	145	121	14	4-19	M16	185	15	126	18	8-19	M16
3-1/2B	9 A	19	155	131	14	4-19	M16	195	16	136	18	8-19	M16
4B	1 A	2	165	141	16	8-19	M16	21	175	151	18	8-19	M16
5B	125A	235	2	176	16	8-19	M16	25	21	182	2	8-23	M20

■ ASME (ANSI) Flange (ASME B16.5-2003)

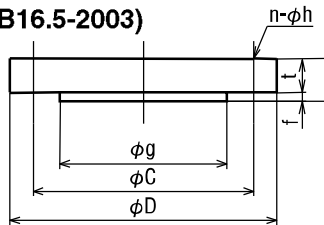

Nominal width	Nominal pres.	150Lb							300Lb						
		D	C	g	t	f	n-h	Bolts	D	C	g	t	f	n-h	Bolts
1B	25A	11	79.4	5 .8	12.7	2	4-16	M14xL55	125	88.9	5 .8	15.9	2	4-19	M16xL65
1-1/4B	32A	115	88.9	63.5	14.3	2	4-16	M14xL55	135	98.4	63.5	17.5	2	4-19	M16xL70
1-1/2B	4 A	125	98.4	73.	15.9	2	4-16	M14xL65	155	114.3	73.	19.1	2	4-22	M20xL75
2B	5 A	15	12 .7	92.1	17.5	2	4-19	M16xL70	165	127.	92.1	2 .7	2	8-19	M16xL75
2-1/2B	65A	18	139.7	1 4.8	2 .7	2	4-19	M16xL75	19	149.2	1 4.8	23.9	2	8-22	M20xL85
3B	8 A	19	152.4	127.	22.3	2	4-19	M16xL75	21	168.3	127.	27.	2	8-22	M20xL90
3-1/2B	9 A	215	177.8	139.7	22.3	2	8-19	M16xL75	23	184.2	139.7	28.6	2	8-22	M20xL95
4B	1 A	23	19 .5	157.2	22.3	2	8-19	M16xL75	255	2 .	157.2	3 .2	2	8-22	M20xL95
5B	125A	255	215.9	185.7	22.3	2	8-22	M20xL85	28	235.	185.7	33.4	2	8-22	M20xL110

■ DIN Flange (DIN2527)

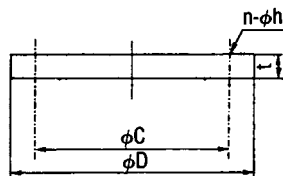

Nominal width	Nominal pres.	PN 6 (kg/cm ²)					PN 10 (kg/cm ²)				
		D	C	t	n-h	Bolts	D	C	t	n-h	Bolts
DN25	1	75	14	4-11	M10	115	85	16	4-14	M12	
DN32	12	9	14	4-14	M12	14	1	16	4-18	M16	
DN40	13	1	14	4-14	M12	15	11	16	4-18	M16	
DN50	14	11	14	4-14	M12	165	125	18	4-18	M16	
DN65	16	13	14	4-14	M12	185	145	18	4-18	M16	
DN80	19	15	16	4-18	M16	2	16	2	8-18	M16	
DN100	21	17	16	4-18	M16	22	18	2	8-18	M16	
DN125	24	2	18	8-18	M16	25	21	22	8-18	M16	